



## Vehicle Feature Tips

Many of the Tips presented below are covered in greater detail in the Owner's Manual, Multimedia System Manuals, Features and Functions Guide, and Quick-Start Guide hangtag supplied with your new vehicle.

### Voice Recognition<sup>1</sup> and Bluetooth<sup>®2</sup>

#### Using Voice Recognition

Improve Bluetooth<sup>®</sup> Voice Recognition (VR) performance by making a few simple changes to your phone contacts:

- Use full names (first and last names) vs. short or single-syllable names ("John Smith" vs. "Dad," "Smith Residence" vs. "Home").
- Avoid using special characters, emojis, and hyphenated names (@, &, #, /, -, \*, +, etc.).
- Avoid using acronyms ("Emergency" vs. "ICE" or "In Case of Emergency") or words with all capital letters.
- Spell words completely; system will not recognize abbreviations ("Doctor Smith" vs. "Dr. Smith").
- Always wait for the beep before speaking any commands.
- When using VR to place a call, speak in a natural, moderate tone, with clear pronunciation. The system may have trouble recognizing commands if you speak too softly or too loudly.
- Open windows, sunroof, weather (wind/rain), or an A/C fan operating at higher speeds can interfere with VR accuracy.
- Your VR system may have difficulty understanding some accents or uncommon names.
- Press the talk button and say "Help" to get a list of available commands.

#### Pairing or Connecting Your Phone with Bluetooth<sup>®</sup>

- Select "Device Connections" in the infotainment display or "Call" button on the steering wheel to begin the pairing process if no phone has previously been paired.
- During the pairing process, please make sure you accept all requests for phonebook download and future auto-connection on your phone.
- To pair a second phone or subsequent phones, reference the manuals and guides supplied with your Sportage as steps vary by infotainment system.

- If you experience any issues with auto-connection, try the following:
  - Reboot your phone (turn the phone off and then on).
  - Update the phone operating system to the most recently released version.
  - Delete the phone from the list of Bluetooth<sup>®</sup> devices on the infotainment system display<sup>1</sup> and delete Kia Connect from the list of Bluetooth<sup>®</sup> devices on your phone, and re-pair.
  - Ensure the phone has the Bluetooth<sup>®</sup> feature activated.
- If some contacts are not downloading to the infotainment system display, check to confirm that the contact has been entered correctly and that it has been stored under the categories (HOME, MOBILE, WORK, iPhone<sup>®3</sup>) that are supported by the infotainment system display. Some contact categories (MAIN, PAGER, OTHER) may not be supported. If the number of contacts exceeds the maximum number allowed on the infotainment system display, contacts will be partially downloaded. Ensure that only the "phone contact list" is selected for contact download on your phone (not social media or email contact lists as these contacts may not download to the infotainment system display).
- Phone operating systems change frequently and some phones may have varying compatibility levels with the Bluetooth<sup>®</sup> system. For any questions regarding the features of your vehicle, please contact your preferred Kia dealer or contact Kia Consumer Assistance at 1-800-333-4542.

#### Other Bluetooth<sup>®</sup> Tips

- Bluetooth<sup>®</sup> reception is affected by carrier coverage and is dependent on the phone.
- If streaming audio through Bluetooth<sup>®</sup> from a device, ensure the listening volume on the device is turned up.

### Smartphone Connectivity<sup>1</sup>



#### Apple CarPlay<sup>®3</sup>

Your vehicle offers you effortless command of your compatible iPhone<sup>®</sup> when you connect through Apple CarPlay<sup>®</sup> on your infotainment system display. This will enable you to make calls, send hands-free texts, access many of your favorite apps and music, and get navigation help with Siri<sup>®</sup> voice control.

To connect Apple CarPlay, visit <https://youtu.be/98TNWMOQfdU>



#### Android Auto<sup>™4</sup>

Your vehicle allows you to connect to your compatible Android<sup>™</sup> phone via Android Auto<sup>™</sup> on your infotainment system display. Through this feature, you can access music, your phone's dialer, navigation help, and more with an intuitive interface and voice commands. You can even access your phone through your steering wheel controls.

To connect Android Auto, visit <https://youtu.be/sTR4KotSOzU>

For select models equipped with wireless Apple CarPlay and Android Auto, visit <https://youtu.be/oUXXuAZAOEI>

### Kia Access App<sup>\*5</sup>



- Your cellphone and your vehicle have to be connected to a cellular network with a good wireless signal strength in order to use Kia Connect (formerly UVO link). If these conditions are not met, remote commands may not execute or may take longer to execute.
- To use Remote Start or Remote Start with Climate Control feature, all doors, hood and trunk/liftgate must be closed and locked. Remote Start or Remote Start with Climate Control feature will operate for about 10 minutes.<sup>6</sup>
- The quickest way to obtain an accurate vehicle status is by pressing the refresh icon on your app or customer web portal.
- Activate Remote Start or Remote Start with Climate Control feature a few minutes before you plan to get into the vehicle. This will allow vehicle interior to reach a desired temperature.
- In order to preserve vehicle battery, Kia Connect will not work seven days after the ignition was last turned on. You will need to re-start your vehicle with a key fob in order to use Kia Connect again.

### Feature Videos

To view a video on your mobile device, snap this QR Code or visit the listed website:  
<https://www.youtube.com/KiaFeatureVideos>



Charging Your Plug-In Hybrid\*

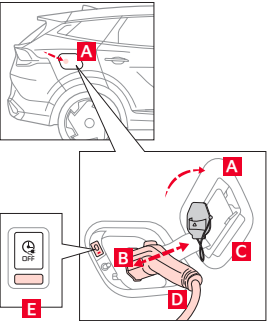

To charge the Plug-In Hybrid vehicle using an AC charger:

- 1. Ensure scheduled charging is not set on the Infotainment System or the Kia Access App.<sup>5</sup>
- 2. Press the brake pedal and engage the parking brake.
- 3. Turn off all switches, put the shift lever in P (Park), and turn off the vehicle.
- 4. With vehicle unlocked, press the rear center edge of the charging door **A** to open.
- 5. Remove any dust or water on the charging connector and charging inlet **B**.
- 6. Remove the charging inlet cover **C**.
- 7. Press the charging connector handle **D** to the charging inlet **B** until you hear a clicking sound.
- 8. Charging will begin automatically. (Ensure the charging indicator **E** is illuminated.)

Checking the Charging Status:

Blinking yellow indicates currently charging between 0-65%. Blinking green indicates currently charging between 65-100%. Blinking red indicates an error while trying to charge. The indicator will turn off within 5 seconds of charging completion.

Smart Cruise Control (SCC) with Stop and Go System\*<sup>7</sup> and Navigation-based Smart Cruise Control (NSCC)\*<sup>8</sup>

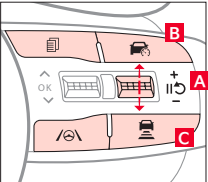

(Buttons located on right side of steering wheel)

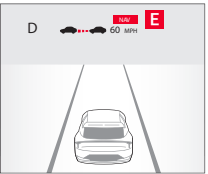
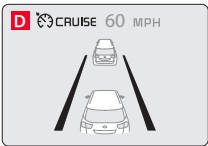

(Display on LCD screen)

SCC is designed to maintain a predetermined distance from vehicles detected ahead by automatically adjusting the driving speed as needed. With SCC on and activated, and the vehicle distance set, the system can slow or bring the vehicle to a complete stop when slowing or stopped traffic is detected ahead.

If the vehicle ahead stops for more than 3 seconds, SCC must be re-engaged by depressing the accelerator pedal or operating the [+], [-] or **A** switch.

To engage SCC and set/adjust the speed:

- Press the button **B** to turn the system ON and set to the current speed. The CRUISE indicator, set speed, and vehicle distance will illuminate on the instrument cluster.
- Increase the set speed by pressing the [+] switch **A** up.
- Decrease the set speed by pressing the [-] switch **A** down.

To pause or resume SCC operation: Press the pause/resume button **A**. The SCC indicator on the instrument cluster display will turn OFF.

To set the vehicle-to-vehicle distance: Press the Vehicle Distance button **C** on the steering wheel. The image on the LCD screen **D** will change when scrolling through the settings.

To turn SCC system OFF: Press the Driving Assist button **B**.

NSCC can automatically adjust the SCC's set vehicle speed according to speed limits and known curves on limited-/controlled-access highways using information from the Navigation System.

To enable NSCC: Go to Vehicle Settings in the Infotainment System, select Driver Assistance, then Driving Convenience, then Highway Auto Speed Change.

When SCC is on and operating, and the vehicle is driving on limited-/controlled-access highways, NSCC will be indicated by the illuminated white NAV icon **E** on the instrument cluster. If SCC is set to the current speed limit on the highway during NSCC operation, the set speed is changed automatically whenever the speed limit changes.

Reminders:

- NSCC requires an active Kia Connect subscription.<sup>5</sup>
- NSCC is only available on controlled access roads and highways.

Lane Keeping Assist (LKA)<sup>7</sup> and Lane Following Assist (LFA)<sup>7</sup>

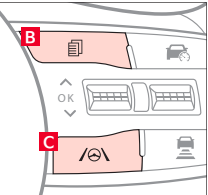
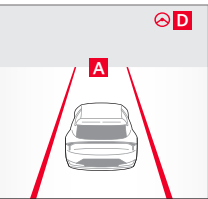

(Buttons located on right side of steering wheel)

LKA is designed to detect the lane markers on the road and alert the driver or assist in steering to potentially help keep the vehicle in the lane. LFA is designed to help the vehicle stay centered in its lane **A** by monitoring the detected lane markings ahead and adjusting the steering.

To enable LKA and/or LFA: Go to User Settings in the instrument cluster display, OR press and hold the Mode button **B** on the right side of the steering wheel, OR press the SETUP key/button on the Infotainment System. Select the VEHICLE button to enter the Vehicle Settings, then Driver Assistance, then Lane Safety.

Once enabled, press and hold the Lane Safety Button or press the Lane Safety Button **C** to turn either system on or off. When on, the Lane Safety icon on the instrument cluster will illuminate gray while the system does not detect the lane markers. When the system detects the lane markers and can assist the steering, the icon will turn green **D**.

**LKA will operate only when** the vehicle speed exceeds approximately 40 mph, LKA recognizes the lane the vehicle is traveling in, and the vehicle is between the lane markers.

**LFA will operate only when** LFA recognizes both sides of the lane markers the vehicle is traveling in and the vehicle is traveling slower than 110 mph.

Forward Collision-Avoidance Assist (FCA)<sup>7</sup>

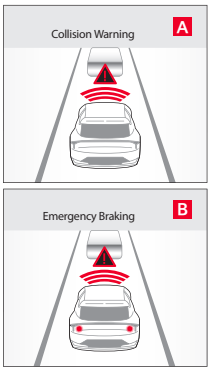

FCA is designed to warn the driver when a collision with a vehicle, pedestrian, or cyclist in the roadway is imminent and, if necessary, temporarily apply emergency braking.

Initially, FCA provides a Forward Collision Warning (FCW) when it detects a potential collision, emitting an audible warning and visual alert on the instrument cluster **A**. If the system detects that the collision risk has increased, FCA automatically applies the brakes to decrease vehicle speed **B**, potentially helping to reduce the effects of a possible collision.

To enable/disable FCA: Go to User Settings, select the Vehicle button, then Driver Assistance, then Forward Safety.

To adjust the FCA initial warning activation time: Go to Vehicle Settings on the Infotainment System, select Setup, then Driver Assistance, then Warning Timing, then Standard or Late, depending on your preference.

**FCA/FCW will operate only when** the Ignition is on or the Power button\* is ON, the vehicle is traveling faster than 3 mph, and Electronic Stability Control (ESC) is ON.

Smart-Power Liftgate Operation\*

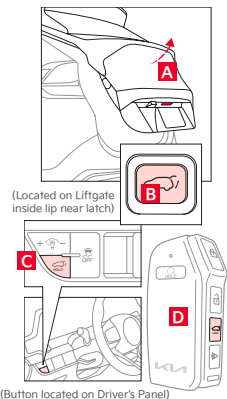

(Located on Liftgate inside lip near latch)

(Button located on Driver's Panel)

From outside the vehicle: Open by pressing the Rear Hatch Release button **A** on exterior of the liftgate, and close by pressing the Power Liftgate Close button **B**.

From inside the vehicle: Open by pressing and briefly holding the Power Liftgate Open/Close button **C**, and **close by pressing and holding the button **C** until liftgate is completely closed.**

Using Smart Key: Open by pressing and holding the liftgate button **D** until the liftgate begins opening, and **close by pressing and holding the button **D** until liftgate is completely closed.**

\*If button is released while closing, the liftgate will stop and a chime will sound.

To set the opening height: Go to Vehicle Settings OR press the Setup key/button on the Infotainment System, select Vehicle, Door, then Power Liftgate Opening Height, OR manually position the liftgate to the preferred height, then press and hold the Power Liftgate Close button **B** more than 3 seconds. A system beep will sound twice indicating the height setting has been saved.

Reminders:

- Pulling the Rear Hatch upward by the handle or pressing the button a second time will interrupt the automatic opening of the Power Liftgate.
- When opening or closing, be mindful of any objects or persons that may be in the way.

Scheduled Charging\*

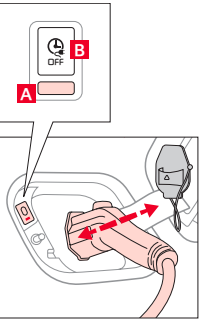

Charging time can be set in the Plug-In Hybrid Infotainment System, under charge management, or using the Kia Access App.<sup>5</sup>

Charging with the Kia Access App:

The Kia Access App can help you find the nearest charging station and displays charging status and the Scheduled Charging information. On your smartphone, go to an app store or marketplace to download the Kia Access App.

**Reminder:** When Scheduled Charging is set and the charger is plugged in, charging will not begin until the set time and date are met to complete the charging. The green charge indicator **A** will temporarily flash ON/OFF to show that Scheduled Charging is set.

Deactivate Scheduled Charging:

Press the Deactivate Scheduled Charging button **OFF B** to disable the scheduled charging feature when immediate charging is required.

Infotainment System / Climate Control Mode Switch Button\*

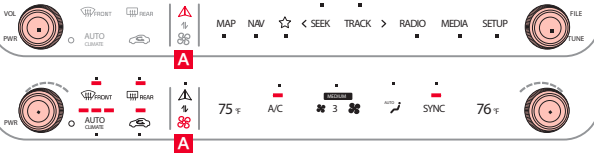

Press to toggle between Infotainment System and Climate Control Modes. Press and hold the Climate Control button **8 A** to set the default button display mode.

Driver Attention Warning (DAW)<sup>9</sup>

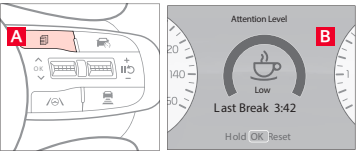

DAW is designed to alert the driver if it detects inattentive driving practices and, in certain situations, can give a warning signal to take a break from driving.

To enable/disable DAW: Go to User Settings in the instrument cluster display, OR press and hold the Mode button **A** on the right side of the steering wheel, OR press the SETUP key/button on the Infotainment System. Select Driver Assistance, then Driving Attention Warning, then Inattentive Driving Warning.

If DAW is activated, the DAW information will appear on the instrument cluster display **B** when you select the Assist mode.

Leading Vehicle Departure Alert (LVDA)

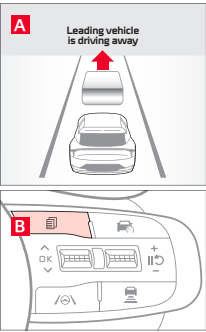

LVDA is a feature of Driver Attention Warning (DAW), and is designed to inform the driver when the vehicle ahead starts moving away or departs from a stop.

When DAW is on and your vehicle is stopped behind another vehicle, the system can detect when the leading vehicle is driving away, and an alert will sound to let you know you can start driving. If no action is taken, a message **A** will appear on the instrument cluster display.

To enable/disable LVDA: Go to User Settings in the instrument cluster display, OR press and hold the Mode button **B** on the right side of the Steering Wheel, OR press the SETUP key/button on the Infotainment System. Select Vehicle Settings, then Driver Assistance, then Driver Attention Warning, then Leading Vehicle Departure Alert.

To adjust the DAW/LVDA initial warning activation time: Go to Vehicle Settings on the Infotainment System, select Setup, then Driver Assistance, then Warning Timing, then Standard or Late, depending on your preference.

Reverse Parking Collision-Avoidance Assist (PCA)\*<sup>7</sup>

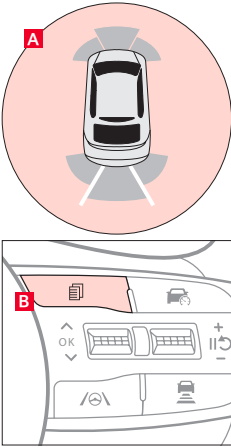

PCA is designed to detect certain objects/pedestrians behind the vehicle and issues an audible warning and/or applies emergency braking to help reduce the possibility of a collision when the vehicle is in reverse. When PCA activates, lines appears behind the vehicle image **A** in the instrument cluster LCD.

To enable/disable PCA: Go to User Settings\* in the instrument cluster display, OR press and hold the Mode button **B** on the right side of the steering wheel, OR press the SETUP key/button to go to Vehicle Settings in the Infotainment System. Select Vehicle Settings, then Driver Assistance, then Parking Safety.

PCA User Settings:

- Rear Active Assist: PCA will warn the driver with an audible alert and may apply temporary braking.
- Rear Warning Only: PCA will warn the driver with an audible alert.
- Off: PCA is disabled.

To adjust the warning volume: Go to Vehicle Settings on the Infotainment System, select Setup, then Vehicle, then Driver Assistance, then Warning Volume. To adjust the warning activation time: Go to Vehicle Settings on the Infotainment System, select Setup, then Vehicle, then Driver Assistance, then Warning Timing, then Standard or Late, depending on your preference.

Panoramic Sunroof Operation with Power Sunshade\*

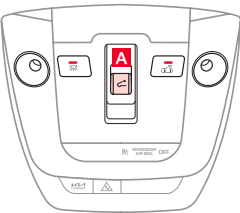

The sunroof operation is controlled through a multidirectional switch. The ignition or Engine Start/Stop button needs to be in the ON position to operate the sunroof.

To slide the sunshade and sunroof:

- Auto Open: Slide the switch **A** backward to the farthest position and release.
- Auto Close: Slide the switch **A** forward to the farthest position and release.

To slide the power sunshade only:

- Auto Open: Slide the switch **A** partially backward to the first detent position and release.
- Auto Close: Slide the switch **A** partially forward to the first detent position and release.

To slide the sunroof (with power sunshade open):

- Open: Slide the switch **A** backward to the first detent position and release.
- Close: Slide the switch **A** forward to the first detent position and release to close sunroof glass only. Slide the switch **A** backward to the farthest position and release to close sunroof glass and sunshade.

To tilt the sunroof:

- Raise: Push switch **A** upward.
- Lower: Push switch **A** forward.

Electronic Parking Brake (EPB)\*

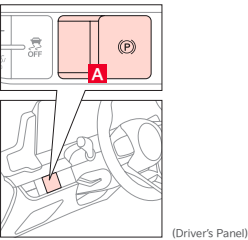

The Electronic Parking Brake (EPB) system utilizes an electric motor to engage the parking brake.

Applying the Parking Brake

Depress the brake pedal and pull up the EPB switch **A**. Ensure that the indicator light is illuminated on the instrument cluster. If parked on a steep incline/decline, pull up the EPB switch for more than 3 seconds for a firmer EPB application.

Releasing the Parking Brake

The EPB will automatically release when the shifter is placed in R (Reverse) or D (Drive). To release EPB manually, depress the brake pedal, then press the EPB switch **A**, with the ignition switch in the ON position. Ensure that the indicator light is OFF.



Surround View Monitor (SVM)\*7

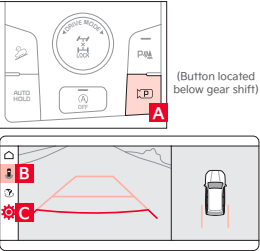

SVM is a parking support system that shows the areas around the front, rear, left, and right sides of the vehicle, as well as a 3D view of the vehicle via the four cameras that's displayed onto the infotainment screen.

To enable/disable SVM Auto On: Press the SETUP key/button on the Infotainment System, select Vehicle Settings, then Driver Assistance, then Parking Safety.

To manually engage SVM: Press the Parking/View button **A**.

To change the SVM settings: Press the onscreen settings icon **C**, while SVM is operating.

To view other modes: Touch the view icons **B** on the SVM screen.

Multimedia USB Port, Power Outlets, & USB Charger Port

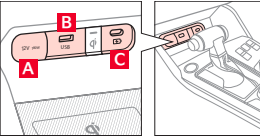

Power Outlets **A**: Charge mobile phones and other devices designed to operate on a 12V (180W max.) power outlet.

Multimedia USB Port **B**: Connect USB audio devices and smartphones to the vehicle.

USB-C Charger Port **C**: Charge mobile phones and other devices using a USB-C cable. The Engine Start/Stop button needs to be in the ACC/ON/START position to operate the USB-C Charger Port.

Wireless Smartphone Charging System<sup>10</sup>

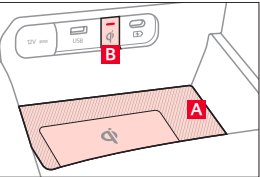

Charge a compatible smartphone wirelessly by placing it on the charging pad **A** at the front of the console, near the Multimedia USB ports and the charging indicator.

To enable Wireless Charging: Go to User Settings in the instrument cluster display or Vehicle Settings in the Infotainment System. Then select Convenience, then Wireless Charging System.

The indicator light **B** may change to amber once wireless charging begins, then to green once charging is complete.

Wireless Smartphone Charging will operate only when all doors are closed and ignition is on.

Blind-Spot View Monitor (BVM)\*11



BVM is designed to display the vehicle's rear and side blind spot areas in the instrument cluster display **A**.

To enable/disable BVM: Press the SETUP key/button on the Infotainment System, select Vehicle Settings, then Driver Assistance, then Blind-Spot Safety, then Blind-Spot View Monitor.

When operating the turn signal, BVM displays video of the blind-spot view for the direction indicated.

BVM will not operate when the Power button is off, a turn signal is deactivated, or another warning screen comes up on the instrument cluster display.

Energy Flow – Instrument Cluster LCD

The instrument cluster LCD screen displays the following Hybrid/Plug-In system modes to inform the driver of its status. To change modes, go to User Settings in the instrument cluster display.

**EV Propulsion:** The electric motor is moving the vehicle.

**Engine-Only Propulsion:** The engine is moving the vehicle.

**Power Reserve:** While the engine powers the vehicle, it is also recharging the Hybrid/Plug-In battery.

**Engine Brake/Regeneration:** The regenerative braking system is recharging the Hybrid/Plug-In battery.

**Power Assist:** Both the electric motor AND the engine are moving the vehicle.

**Engine Generation:** While the vehicle is stopped, the engine is charging the Hybrid/Plug-In battery.

**Vehicle Stop:** The vehicle's Hybrid/Plug-In system is standing by.

**Engine Generation/Regeneration:** The engine and the braking system are both recharging the Hybrid/Plug-In battery.



**KIA** Movement that inspires

2023 Sportage Turbo-Hybrid EX shown on cover. Images or graphics for illustration only. \*If equipped. <sup>1</sup>Driving while distracted can result in a loss of vehicle control that may lead to an accident, severe personal injury, and death. The driver's primary responsibility is in the safe and legal operation of a vehicle, and use of any handheld devices, other equipment, or vehicle systems which take the driver's eyes, attention, and focus away from the safe operation of a vehicle or which are not permissible by law should never be used during operation of the vehicle. <sup>2</sup>The Bluetooth® word mark and logos are registered trademarks owned by Bluetooth SIG, Inc. and any use of such marks by Kia is under license. A Bluetooth® enabled cell phone is required to use Bluetooth® Wireless Technology. <sup>3</sup>Apple CarPlay, iPhone, and Siri are registered trademarks of Apple Inc., registered in the U.S. and other countries. CarPlay runs on your smartphone cellular data service. Normal data rates will apply. <sup>4</sup>Android Auto vehicle user interface is a product of Google and its terms and privacy statements apply. Requires the Android Auto app on Google Play™ store and an Android compatible smartphone running Android 5.0 Lollipop or higher. Data plan rates apply. Android, Android Auto, and Google Play are trademarks of Google LLC or its affiliates. <sup>5</sup>Purchase/lease of certain 2022 and newer Kia vehicles with Kia Connect (formerly UVO link) includes a complimentary 1-year subscription starting from new vehicle retail sale/lease date as recorded by the dealer. After your complimentary 1-year Kia Connect subscription expires, continued access to the full suite of Kia Connect services available on your Kia will require a paid subscription at the then current subscription rate or your use of certain Kia Connect features may immediately terminate. Use of Kia Connect is subject to agreement to the Kia Connect Privacy Policy (available at owners.kia.com/us/en/privacy-policy.html) and Terms of Service (available at owners.kia.com/us/en/terms-of-service.html). Kia Connect is transferable to subsequent owner during the original Kia Connect service term. Only use Kia Connect when safe to do so. Kia Access App is available from the Apple® App Store® or Google Play™ store. Kia America, Inc. reserves the right to change or discontinue Kia Connect at any time without prior notification or incurring any future obligation. Message and data rates may apply. Cellular and GPS coverage are required to use most features. Kia Connect features may vary by model, model year, and trim level. Features, specifications, and fees are subject to change. For more on details and limitations, visit www.kia.com or your authorized Kia dealer. Apple and App Store are registered trademarks of Apple Inc. Google and logos are trademarks of Google LLC. Kia Connect may currently be unavailable for Model Year 2022 and newer vehicles sold or purchased in Massachusetts; please see the Kia Owner's Portal for updates on availability. <sup>6</sup>Do not use remote climate control or remote start if vehicle is in an enclosed area (e.g., closed garage) or a partially enclosed area without ventilation. Close all doors leading from adjacent living areas to the vehicle area before executing a remote climate control or remote start command. <sup>7</sup>Driver-assist technologies are not substitutes for safe driving, and may not detect all objects surrounding vehicle. Always drive safely and use caution. <sup>8</sup>When engaged, Navigation-based Smart Cruise Control (NSCC) is not a substitute for safe driving and cruise-control procedures. This is not an auto-pilot feature. It may not detect every object around the vehicle. Always drive safely and use caution. <sup>9</sup>When engaged, Driver Attention Warning is not a substitute for safe driving and may not detect all instances of inattentive driving practices. Failure to pay attention to travel conditions and vehicle operation could result in loss of vehicle control. Always drive safely and use caution. <sup>10</sup>Charging system only works with select devices. Refer to the vehicle's Owner's Manual for warnings and instructions. <sup>11</sup>When engaged, Blind-Spot View Monitor is not a substitute for safe driving and may not display all objects around vehicle. Always drive safely and use caution. <sup>12</sup>Kia received the fewest reported problems among mass market brands in the J.D. Power 2022 U.S. Vehicle Dependability Studies based on 2019 models. See jdpower.com/awards for 2022 details.

©2022 Kia America, Inc., 111 Peters Canyon Road, Irvine, CA 92606