



Vehicle Feature Tips

Many of the Tips presented below are covered in greater detail in the Owner's Manual, Multimedia System Manuals, Features and Functions Guide, and Quick-Start Guide hangtag supplied with your new vehicle.

Voice Recognition¹ and Bluetooth^{®2}

Using Voice Recognition

Improve Bluetooth[®] Voice Recognition (VR) performance by making a few simple changes to your phone contacts:

- Use full names (first and last names) vs. short or single-syllable names ("John Smith" vs. "Dad," "Smith Residence" vs. "Home").
- Avoid using special characters, emojis, and hyphenated names (@, &, #, /, -, *, +, etc.).
- Avoid using acronyms ("Emergency" vs. "ICE" or "In Case of Emergency") or words with all capital letters.
- Spell words completely; system will not recognize abbreviations ("Doctor Smith" vs. "Dr. Smith").
- Always wait for the beep before speaking any commands.
- When using VR to place a call, speak in a natural, moderate tone, with clear pronunciation. The system may have trouble recognizing commands if you speak too softly or too loudly.
- Open windows, sunroof, weather (wind/rain), or an A/C fan operating at higher speeds can interfere with VR accuracy.
- Your VR system may have difficulty understanding some accents or uncommon names.
- Press the talk button and say "Help" to get a list of available commands.

Pairing or Connecting Your Phone with Bluetooth[®]

- Select "Device Connections" in the infotainment system display¹ or "Call" button on the steering wheel to begin the pairing process if no phone has previously been paired.
- During the pairing process, please make sure you accept all requests for phonebook download and future auto-connection on your phone.
- To pair a second phone or subsequent phones, reference the manuals and guides supplied with your Sportage as steps vary by infotainment system.

- If you experience any issues with auto-connection, try the following:
 - Reboot your phone (turn the phone off and then on).
 - Update the phone operating system to the most recently released version.
 - Delete the phone from the list of Bluetooth[®] devices on the infotainment system display and delete Kia device from the list of Bluetooth[®] devices on your phone, and re-pair.
 - Ensure the phone has the Bluetooth[®] feature activated.
- If some contacts are not downloading to the infotainment system display, check to confirm that the contact has been entered correctly and that it has been stored under the categories (HOME, MOBILE, WORK, iPhone^{®3}) that are supported by the infotainment system display. Some contact categories (MAIN, PAGER, OTHER) may not be supported. If the number of contacts exceeds the maximum number allowed on the infotainment system display, contacts will be partially downloaded. Ensure that only the "phone contact list" is selected for contact download on your phone (not social media or email contact lists as these contacts may not download to the infotainment system display).
- Phone operating systems change frequently and some phones may have varying compatibility levels with the Bluetooth[®] system. For any questions regarding the features of your vehicle, please contact your preferred Kia dealer or contact Kia Consumer Assistance at 1-800-333-4542.

Other Bluetooth[®] Tips

- Bluetooth[®] reception is affected by carrier coverage and is dependent on the phone.
- If streaming audio through Bluetooth[®] from a device, ensure the listening volume on the device is turned up.

Smartphone Connectivity¹



Apple CarPlay^{®3}

Your vehicle offers you command of your compatible iPhone[®] when you connect through Apple CarPlay[®] on your infotainment system display. This will enable you to make calls, send hands-free texts, access many of your favorite apps and music, and get navigation help with Siri[®] voice control.

To connect Apple CarPlay, visit <https://youtu.be/98TNWMOQfdU>



Android Auto^{™4}

Your vehicle allows you to connect to your compatible Android[™] phone via Android Auto[™] on your infotainment system display. Through this feature, you can access music, your phone's dialer, navigation help, and more with an intuitive interface and voice commands. You can even access your phone through your steering wheel controls.

To connect Android Auto, visit <https://youtu.be/sTR4KotSOzU>

For select models equipped with wireless Apple CarPlay and Android Auto, visit <https://youtu.be/oUXXuAZAOEI>

Kia Access App^{*5}



- Your cell phone and your vehicle have to be connected to a cellular network with a good wireless signal strength in order to use Kia Connect (formerly UVO link). If these conditions are not met, remote commands may not execute or may take longer to execute.
- To use Remote Start or Remote Start with Climate Control feature, all doors, hood and trunk/liftgate must be closed and locked. Remote Start or Remote Start with Climate Control feature will operate for 10 minutes, and then the vehicle shuts off automatically.⁶
- Activate Remote Start or Remote Start with Climate Control feature a few minutes before you plan to get into the vehicle. This will allow vehicle interior to reach a desired temperature.
- The quickest way to obtain an accurate vehicle status is by pressing the refresh icon on your app or customer web portal.
- In order to help preserve vehicle battery, Kia Connect will not work seven days after the ignition was last turned on. You will need to re-start your vehicle with a key fob in order to use Kia Connect again.

Feature Videos

To view a video on your mobile device, snap this QR Code or visit the listed website: <https://www.youtube.com/KiaFeatureVideos>



Smart Cruise Control (SCC) with Stop and Go*⁷ and Navigation-Based Smart Cruise Control (NSCC)**⁸

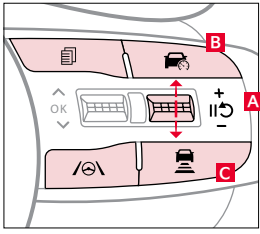

(Buttons located on right side of steering wheel)

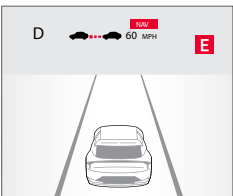
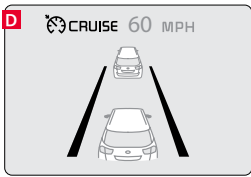

(Displays on LCD screen)

SCC is designed to maintain a predetermined distance from vehicles detected ahead by automatically adjusting the driving speed as needed. With SCC on and activated, and the vehicle distance set, the system can slow or bring the vehicle to a complete stop when slowing or stopped traffic is detected ahead. If the vehicle ahead stops for more than 3 seconds, SCC must be re-engaged by depressing the accelerator pedal or operating the [+] or [-] switch **A**.

To engage SCC and set/adjust the speed:

- Press the button **B** to turn the system ON and set to the current speed. The CRUISE indicator, set speed, and vehicle distance will illuminate on the Instrument Cluster.
- Increase the set speed by pressing the [+] switch **A** up.
- Decrease the set speed by pressing the [-] switch **A** down.

To pause or resume SCC operation: Press the pause/resume button **A**. The SCC indicator on the Instrument Cluster display will turn OFF.

To set the vehicle-to-vehicle distance: Press the Vehicle Distance button **C** on the steering wheel. The image on the LCD screen **D** will change when scrolling through the settings.

To turn SCC system OFF: Press the Driving Assist button **B**.

NSCC can automatically adjust the SCC's set vehicle speed according to speed limits and known curves on limited-/controlled-access highways using information from the navigation system.

To enable NSCC: Go to Vehicle Settings in the infotainment system, select Driver Assistance > Driving Convenience > Highway Auto Speed Change.

When SCC is ON and operating, and the vehicle is driving on limited-/controlled-access highways, NSCC will be indicated by the illuminated WHITE NAV icon **E** on the Instrument Cluster. If SCC is set to the current speed limit on the highway during NSCC operation, the set speed is changed automatically whenever the speed limit changes.

Reminder: NSCC requires an active navigation subscription⁵ and is only available on limited-/controlled-access highways. The driver needs to remain alert at all times, even when the SCC with Stop and Go System and NSCC are activated, and be prepared to take full control of the vehicle in case of any sudden change in road and/or traffic conditions.

Lane Keeping Assist (LKA)⁹ and Lane Following Assist (LFA)⁹

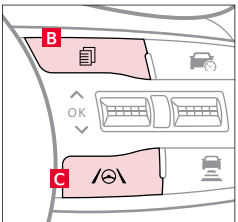
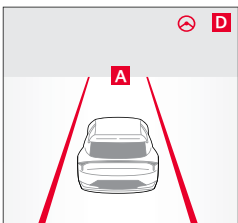

(Buttons located on right side of steering wheel)

LKA is designed to detect lane markings (or road edges) and can warn the driver if the vehicle leaves the lane without using the turn signal and can, in certain circumstances, assist with steering to prevent the vehicle departing from its travel lane. LFA is designed to help ensure that the vehicle stays centered in its lane **A** by monitoring the detected lane markings ahead and vehicles on the road, and may provide steering inputs.

To enable LKA and/or LFA: Press and hold the Mode button **B** on the right side of the steering wheel to go to Driving Assist, OR press the SETUP key/button on the infotainment system. Select the VEHICLE button to enter the Vehicle Settings > Driver Assistance > Lane Safety.

Once enabled, press and hold the Lane Safety Button **C** to turn LKA on or off. When ON, the Lane Safety icon on the Instrument Cluster will illuminate WHITE while the system does not detect the lane markers. When the system detects the lane markers and can assist the steering, the icon will turn GREEN **D**.

To set/adjust Volume and Priority: Go to Vehicle Settings* in the infotainment system or Driving Assist in the Instrument Cluster display and in Driver Assistance, press Warning Methods and adjust the Warning Volume.

LFA Hands-OFF Warning: If the driver removes their hands from the steering wheel for several seconds, a warning message will appear on the Instrument Cluster, and an audible warning will sound. If the driver's hands are not replaced on the steering wheel, LFA will cancel.

LKA will operate only when these conditions are met:

- The vehicle speed exceeds approximately 40 mph.
- LKA recognizes the lane the vehicle is traveling in.
- The vehicle is between the lane markers.

LFA will operate only when these conditions are met:

- LFA recognizes both sides of the lane markers the vehicle is traveling in.
- The vehicle is traveling slower than 110 mph.

Forward Collision-Avoidance Assist (FCA)⁹

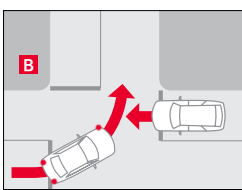
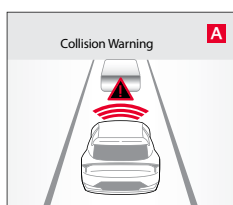

(Junction Turning)

FCA is designed to warn the driver when it detects the risk of a collision with a vehicle, pedestrian, or cyclist in the roadway and, in certain circumstances, temporarily apply emergency braking.

Initially, FCA provides a Forward Collision Warning (FCW) when it detects a potential collision with a vehicle, pedestrian, or cyclist in front by emitting an audible warning and visual alert on the Instrument Cluster **A**. If the system detects that the collision risk has increased, FCA can automatically apply the brakes to reduce your speed, potentially helping to reduce the effects of a possible collision. Junction Turning function* **B** may apply emergency braking to help avoid a collision with an oncoming vehicle detected in an adjacent lane when turning left at a crossroad with the turn signal on.

To enable/disable FCA: Go to User Settings, select the VEHICLE button to enter the Vehicle Settings* > Driver Assistance > Forward Safety.

To adjust the FCA initial warning activation time: Press the SETUP key/button on the infotainment system. Select the VEHICLE button to enter the Vehicle Settings* > Driver Assistance > Warning Timing > Standard or Late, depending on your preference.

FCA/FCW will operate only when these conditions are met:

- Ignition is ON or the Power button* is ON.
- Vehicle is traveling faster than 3 mph.
- Electronic Stability Control (ESC) is ON.

Smart-Power Liftgate Operation*¹⁰

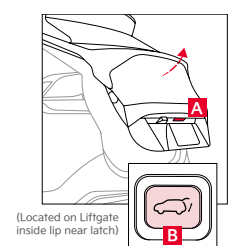

(Located on Liftgate inside lip near latch)

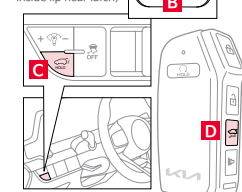

(Button located on Driver's Panel)

From outside of the vehicle: Open by pressing the Liftgate Release button **A** on exterior of the Liftgate, and close by pressing the Power Liftgate Close button **B**.

From inside of the vehicle: Open by pressing and briefly holding the Power Liftgate Open/Close button **C**, and close by pressing and holding the button **C** until Liftgate is completely closed.¹

Using the Smart Key: Open by pressing and holding the Liftgate button **D** until the Liftgate begins opening, and close by pressing and holding the button **D** until Liftgate is completely closed.¹

¹If button is released while closing, the Liftgate will stop and a chime will sound.

To set the opening height: Go to Vehicle Settings OR press the SETUP key/button on the infotainment system, select VEHICLE > Door > Power Liftgate Opening Height, OR manually position the Liftgate to the preferred height, then press and hold the Power Liftgate Close button **B** more than 3 seconds. A system beep will sound twice indicating the height setting has been saved.

Reminders:

- Pulling the Liftgate upward by the handle or pressing the button a second time will interrupt the automatic opening of the Power Liftgate.
- When opening or closing, be mindful of any objects or persons that may be in the way.

Infotainment System / Climate Control Mode Switch Button*

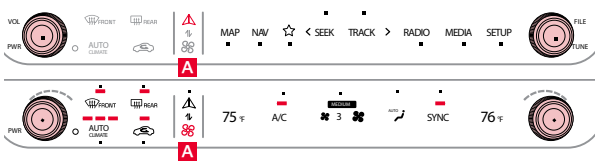

Press to toggle between infotainment system and Climate Control Modes. Press and hold the Climate Control button **A** to set the default button display mode.

Accessory Mode with Smart Key*

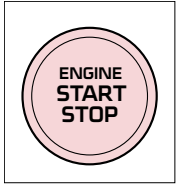

With standard key vehicles, you can turn the key to the accessory mode and utilize the electronic accessories without starting the vehicle. This is still possible with Smart Key-equipped vehicles. To do this, enter the vehicle with the Smart Key and push the Engine Start/Stop button one time without depressing the brake pedal. This will put the vehicle in Accessory mode and ACC will illuminate in AMBER.

Keeping the vehicle in ACC or the ON position for extended periods of time without turning the engine on may discharge the vehicle's battery.

Driver Attention Warning (DAW)¹¹

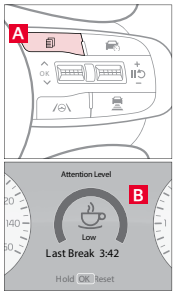

DAW is designed to alert the driver if it detects inattentive driving practices and, in certain situations, can give a warning signal to take a break from driving.

To enable/disable DAW: Press and hold the Mode button **A** on the right side of the steering wheel to go to Driving Assist, OR press the SETUP key/button on the infotainment system. Select Driver Assistance > Driving Attention Warning > Inattentive Driving Warning.

If DAW is activated, the DAW information will appear on the Instrument Cluster **B** when you select the Assist mode.

Leading Vehicle Departure Alert (LVDA)⁹

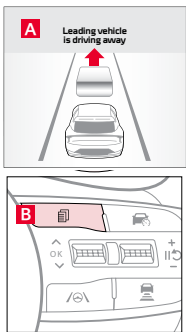

LVDA is a feature of Driver Attention Warning (DAW), and is designed to inform the driver when the vehicle ahead starts to move away or departs from a stop.

When DAW is ON and your vehicle is stopped behind another vehicle, the system can detect when the leading vehicle is driving away, and an alert will sound to let you know. If no action is taken, a message **A** will appear on the Instrument Cluster.

To enable/disable LVDA: Press and hold the Mode button **B** on the right side of the steering wheel to go to Driving Assist, OR press the SETUP key/button on the infotainment system. Select Vehicle Settings > Driver Assist > Driver Attention Warning > Leading Vehicle Departure Alert.

To adjust the DAW/LVDA initial warning activation time: Go to Vehicle Settings on the infotainment system, select SETUP > Driver Assistance > Warning Timing > Standard or Late, depending on your preference.

Parking Collision-Avoidance Assist-Reverse (PCA-R)⁹

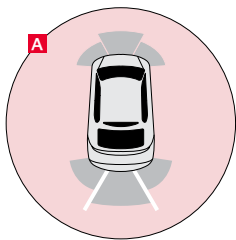

PCA-R is designed to detect certain objects/pedestrians behind the vehicle and issues an audible warning and/or applies emergency braking to help reduce the possibility of a collision when the vehicle is in reverse. When PCA-R activates, lines appear behind the vehicle image **A** in the Instrument Cluster.

To enable/disable PCA-R: Press and hold the Mode button **B** on the right side of the steering wheel to go to Driving Assist, OR press the SETUP key/button to go to Vehicle Settings in the infotainment system. Select Vehicle Settings > Driver Assistance > Parking Safety.

PCA User Settings:

- **Rear Active Assist:** PCA-R will warn the driver with an audible alert and may apply temporary braking.
- **Rear Warning Only:** PCA-R will warn the driver with an audible alert.
- **Off:** PCA-R is disabled.

To adjust the warning volume: Go to Vehicle Settings on the infotainment system, select SETUP > Vehicle > Driver Assistance > Warning Volume.

To adjust the warning activation time: Go to Vehicle Settings on the infotainment system, select SETUP > Vehicle > Driver Assistance > Warning Timing > Standard or Late, depending on your preference.

Panoramic Sunroof Operation with Power Sunshade*

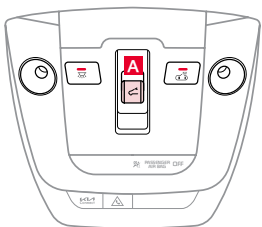

The sunroof operation is controlled through a multidirectional switch. The ignition or Engine Start/Stop button needs to be in the ON position to operate the sunroof.

To slide the sunshade and sunroof:

- **Auto Open:** Slide switch **A** backward to the farthest position and release.
- **Auto Close:** Slide switch **A** forward to the farthest position and release.

To slide the power sunshade only:

- **Auto Open:** Slide switch **A** partially backward to the first detent position and release.
- **Auto Close:** Slide switch **A** partially forward to the first detent position and release.

To slide the sunroof (with power sunshade open):

- **Open:** Slide switch **A** backward to the first detent position and release.
- **Close:** Slide switch **A** forward to the first detent position and release to close sunroof glass only. Slide the lever backward to the farthest position and release to close sunroof glass and sunshade.

To tilt the sunroof:

- **Raise:** Push switch **A** upward.
- **Lower:** Push switch **A** forward.

Electronic Parking Brake (EPB)*

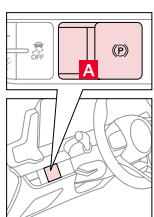

(Driver's Panel)

The EPB system utilizes an electric motor to engage the parking brake.

To apply the parking brake: Depress the brake pedal and pull up the EPB switch **A**. Ensure that the indicator light is illuminated on the Instrument Cluster. If parked on a steep incline/decline, pull up the EPB switch for more than 3 seconds for a firmer EPB application.

To release the parking brake: The EPB will automatically release when the shifter is placed in R (Reverse) or D (Drive). To release EPB manually, depress the brake pedal, then press the EPB switch **A**, with the ignition switch in the ON position. Ensure that the indicator light is OFF.

Surround View Monitor (SVM)*1,9

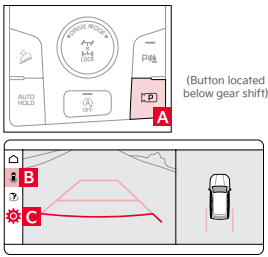

SVM is a parking assist system that shows the areas around the front, rear, left, and right sides of the vehicle, as well as a 3D view of the vehicle via the four cameras that's displayed onto the infotainment screen.

To enable/disable SVM Auto On: Press the SETUP key/button on the infotainment system, select Vehicle Settings > Driver Assistance > Parking Safety.

To manually engage SVM: Press the Parking/View button **A**.

To change the SVM settings: Press the onscreen settings icon **C**, while SVM is operating.

To view other modes: Touch the views icon **B** on the SVM screen.

Power Outlets, Multimedia USB Port, and USB-C Charger Port

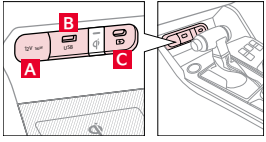

Power Outlets **A:** Charge mobile phones and other devices designed to operate on a 12V (180W max.) power outlet.

Multimedia USB Port **B:** Access media and other files on smart devices or USB sticks.

USB-C Charger Port **C:** Charge mobile phones and other devices using a USB-C cable. The Engine Start/Stop button needs to be in the ACC/ON/START position to operate the USB-C Charger Port.

Wireless Smartphone Charging System*12

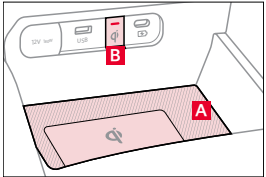

Charge a compatible smartphone wirelessly by placing it on the charging pad **A** at the front of the console, near the Multimedia USB ports and the charging indicator.

To enable Wireless Charging: Go to Vehicle Settings in the infotainment system. Then select Convenience > Wireless Charging System.

The indicator light **B** may change to AMBER once wireless charging begins, then to GREEN once charging is complete.

For wireless charging to occur, all doors (excluding the Liftgate) must be closed, and the Smart Key must be detected inside the vehicle.

Blind-Spot View Monitor (BVM)*13

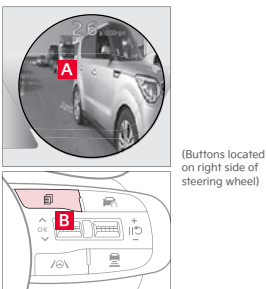

BVM is designed to display the vehicle's rear and side blind spot areas in the Instrument Cluster **A**.

To enable/disable BVM: Press and hold the Mode button **B** on the right side of the steering wheel to go to Driving Assist, OR press the SETUP key/button on the infotainment system. Select Vehicle > Driver Assistance > Blind-Spot Safety > Blind-Spot View.

When operating the turn signal, BVM displays video of the blind-spot view for the direction indicated.

BVM will not operate when the Power button is OFF, a turn signal is deactivated, or another warning screen comes up on the Instrument Cluster.

Auto Hold*

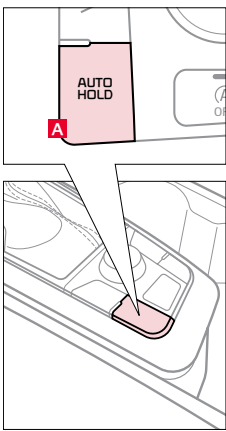

Auto Hold temporarily keeps the vehicle at a standstill without the brake pedal being depressed after the vehicle has come to a complete stop.

To enable/disable Auto Hold: Press the AUTO HOLD button **A** on the center console below the gear shift.

The Auto Hold indicator on the Instrument Cluster has four states:

Standby: With vehicle at a standstill and AUTO HOLD button **A** pressed ON, the indicator will illuminate WHITE. While vehicle is in motion, the Auto Hold indicator will remain WHITE.

Engaged: When coming to a complete stop by depressing the brake pedal, the Auto Hold indicator changes from WHITE to GREEN.

Not Illuminated: The indicator will turn OFF when the AUTO HOLD button **A** is manually pressed OFF.

Malfunction: When the indicator is illuminated AMBER, there may be a system malfunction. Take your vehicle to a local Kia dealer.

Reminder: Before Auto Hold will operate, the driver's door, engine hood, and liftgate must be closed.



#1 for Long-Term Dependability
among Mass Market Brands for 3 Years in a Row (2021-2023)*14



Movement that inspires

2024 Sportage X-Pro Prestige shown on cover. Images or graphics for illustration only. *If equipped. ¹Driving while distracted can result in a loss of vehicle control that may lead to an accident, severe personal injury, and death. The driver's primary responsibility is in the safe and legal operation of a vehicle. Remain attentive to driving and be cautious when using steering wheel-mounted controls while driving. Use of any handheld devices, other equipment, or vehicle systems that take the driver's eyes, attention, and focus away from the safe operation of a vehicle or which are not permissible by law should never be used during the operation of the vehicle. ²The Bluetooth® word mark and logos are registered trademarks owned by Bluetooth SIG, Inc. and any use of such marks by Kia is under license. A Bluetooth® enabled cell phone is required to use Bluetooth® Wireless Technology. ³Apple CarPlay, iPhone, and Siri are registered trademarks of Apple Inc., registered in the U.S. and other countries. CarPlay runs on your smartphone cellular data service. Normal data rates will apply. ⁴Android Auto vehicle user interface is a product of Google and its terms and privacy statements apply. Requires the Android Auto app on Google Play™ store and an Android compatible smartphone running Android 5.0 Lollipop or higher. Data plan rates apply. Android, Android Auto, and Google Play are trademarks of Google LLC or its affiliates. ⁵Purchase/lease of certain 2024 and newer Kia vehicles with Kia Connect (formerly known as UVO link) includes a complimentary 1-year subscription to Kia Connect Ultimate, our most comprehensive Kia Connect package, starting from the new vehicle retail sale/lease date as recorded by the dealer. After your complimentary 1-year Kia Connect Ultimate subscription expires, continued access to the full suite of Kia Connect features available on your Kia will require a paid subscription at the then-current subscription rate or your use of certain Kia Connect features may immediately terminate. Use of Kia Connect is subject to agreement to the Kia Connect Privacy Policy and Terms of Service. Complimentary Kia Connect subscriptions are transferable to subsequent owners during the original Kia Connect service term. Only use Kia Connect when safe to do so. Kia Access App is available from the Apple® App Store® or Google Play™. Kia America, Inc. reserves the right to change or discontinue Kia Connect at any time without prior notification or incurring any future obligation. Message and data rates may apply. Cellular and GPS coverage is required to use most features. Kia Connect features may vary by model, model year, and trim level. Features, specifications, and fees are subject to change. Kia Connect is currently unavailable for Model Year 2022 and newer vehicles sold in Massachusetts; please see the Kia Owners Portal for updates on availability. For more on details and limitations, visit www.kia.com or your authorized Kia dealer. Apple and App Store are registered trademarks of Apple Inc. Google and logos are trademarks of Google, LLC. ⁶Do not use remote climate control or remote start if vehicle is in an enclosed area (e.g., closed garage) or a partially enclosed area without ventilation. Close all doors leading from adjacent living areas to the vehicle area before executing a remote climate control or remote start command. ⁷When engaged, Smart Cruise Control with Stop and Go is not a substitute for safe driving and cruise-control procedures. This is not an auto-pilot feature. Always drive safely and use caution. The Smart Cruise Control system may not detect every object in front of the vehicle. ⁸When engaged, Navigation-Based Smart Cruise Control (NSCC) is not a substitute for safe driving and cruise-control procedures. This is not an auto-pilot feature. It may not detect every object around the vehicle. Always drive safely and use caution. ⁹Driver-assist technologies are not substitutes for safe driving, and may not detect all objects surrounding vehicle. Always drive safely and use caution. ¹⁰Driving with the liftgate open may be unlawful and can draw dangerous exhaust fumes into your vehicle; if you choose to do so, keep air vents and all windows open for proper ventilation. ¹¹When engaged, Driver Attention Warning is not a substitute for safe driving and may not detect all instances of inattentive driving practices. Failure to pay attention to travel conditions and vehicle operation could result in loss of vehicle control. Always drive safely and use caution. ¹²Charging system only works with select devices. Refer to the vehicle's Owner's Manual for warnings and instructions. ¹³When engaged, Blind-Spot View Monitor is not a substitute for safe driving and may not display all objects around vehicle. Always drive safely and use caution. ¹⁴2023 Kia EV6 GT-Line, 2024 K5 GT, 2023 Sportage Plug-in Hybrid X-Line, and 2023 Telluride SX X-Pro shown with optional features. Not all optional features available on all trims. Some features may vary. Kia received the fewest reported problems among mass market brands in the J.D. Power 2021-2023 U.S. Vehicle Dependability Study. 2023 Study based on 2020 models. See jdpower.com/awards for 2023 details.